

#### Technical Data

**Burner Model:**

**Heat Output:**

**Clearances to**

**Combustibles:**

**Available Finishes:**

**Available Accessories:**

**Burner Certifications**

**& Standards:**

**Installed Weight:**

**Crated Weight:**

**Crate Size:**

**Vessel Material & Weight:**

**Natural Gas**

CIR-M-24

140,000 BTU/h

Above: 82" Below: 0" Sides: 11"

Charcoal, Ash, Dove, Walnut, Chai, Nougat

Aluminum Table Top

US & Canada - CSA ANSI Z21.97 CSA 2.4.1

up to 600 lbs | 275 kg

up to 750 lbs / 340 kg

54"x54"x25"h / 137x137x63 cm

Hand Cast Concrete 225 lbs / 102 kg

**Propane**

CIR-M-24P

140,000 BTU/h

For more information, visit [paloform.com/fire-pits/miso](http://paloform.com/fire-pits/miso)



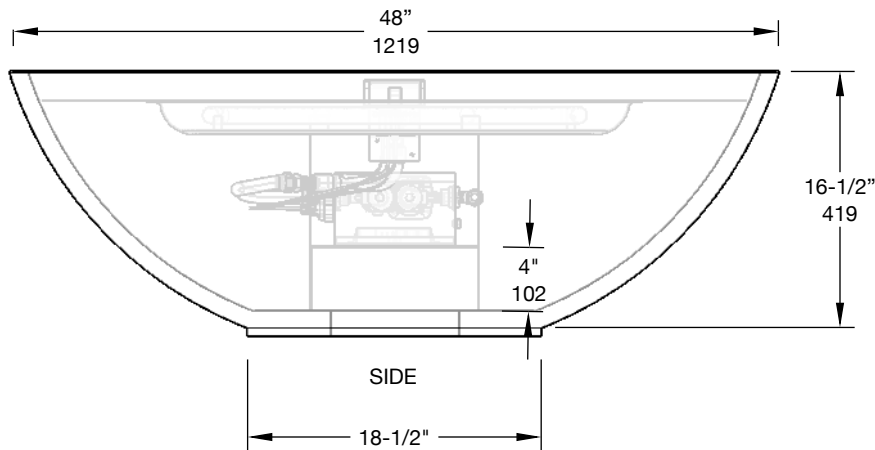
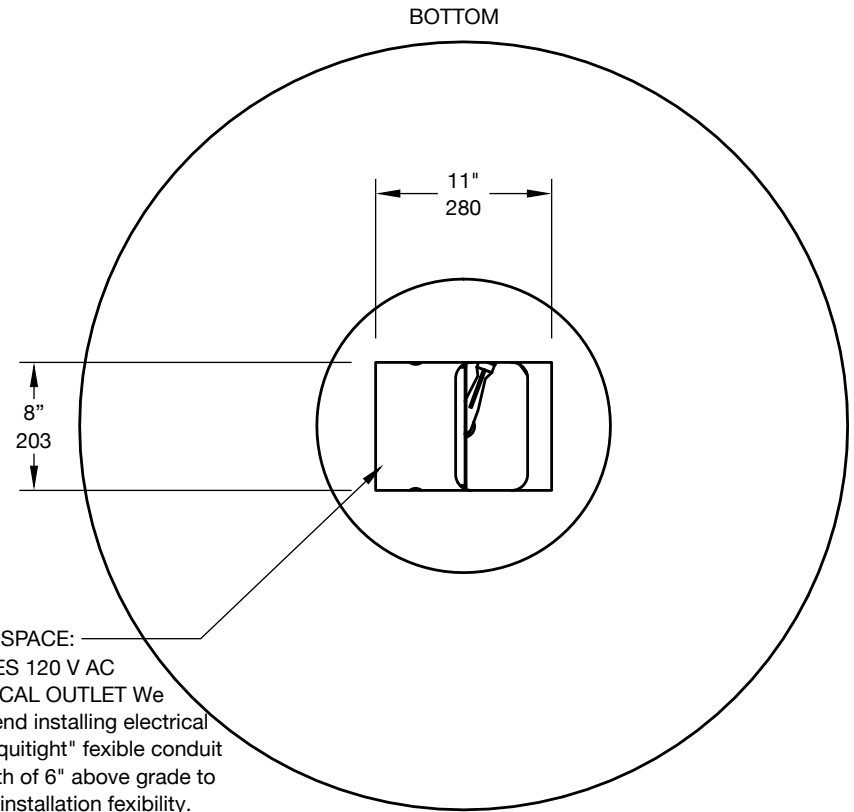
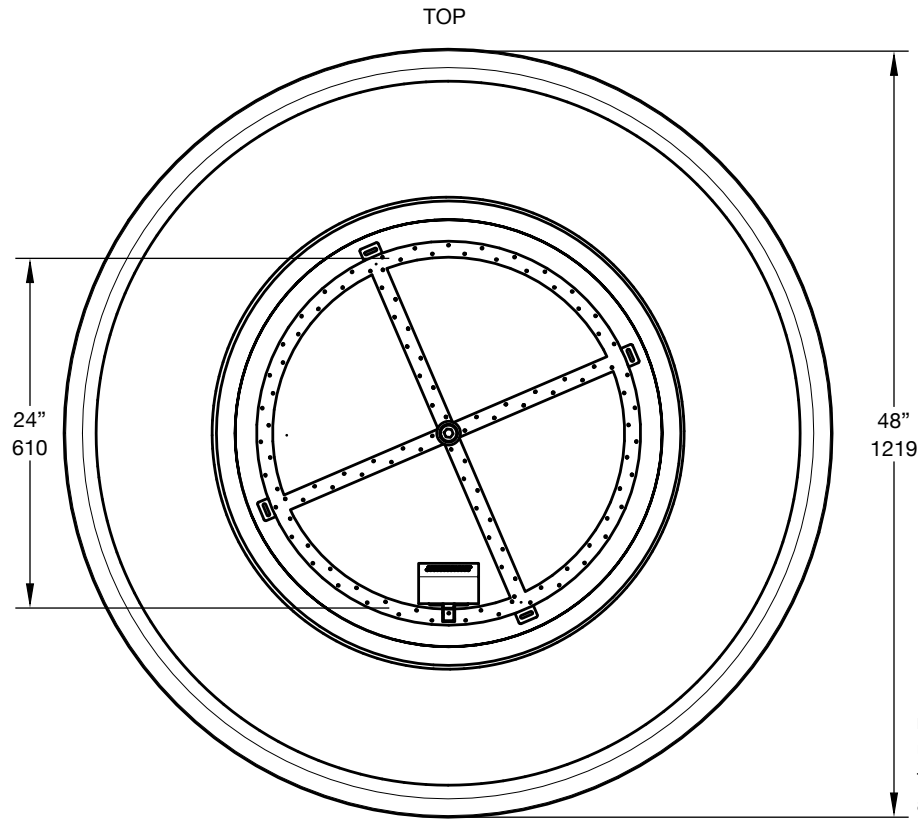

#### Technical Data

**Burner Model:**

**Heat Output:**

**Clearances to**

**Combustibles:**

**Available Finishes:**

**Available Accessories:**

**Burner Certifications**

**& Standards:**

**Installed Weight:**

**Crated Weight:**

**Crate Size:**

**Vessel Material & Weight:**

**Natural Gas**

CIR-E-24

140,000 BTU/h

**Propane**

CIR-E-24P

140,000 BTU/h

Above: 82" Below: 0" Sides: 11"

Charcoal, Ash, Dove, Walnut, Chai, Nougat

Aluminum Table Top

US & Canada - CSA ANSI Z21.97 CSA 2.4.1

up to 600 lbs | 275 kg

up to 750 lbs / 340 kg

54"x54"x25"h / 137x137x63 cm

Hand Cast Concrete 225 lbs / 102 kg

For more information, visit [paloform.com/fire-pits/miso](http://paloform.com/fire-pits/miso)

